

Linear feeder

HLF07-P & HLF12-P



- Higher vibration frequencies up to 240 Hz for even more gentle conveying of parts
- No mechanical adjustment of the natural frequency and therefore not susceptible to interference
- Same outer geometries as HLF-M series

Overview

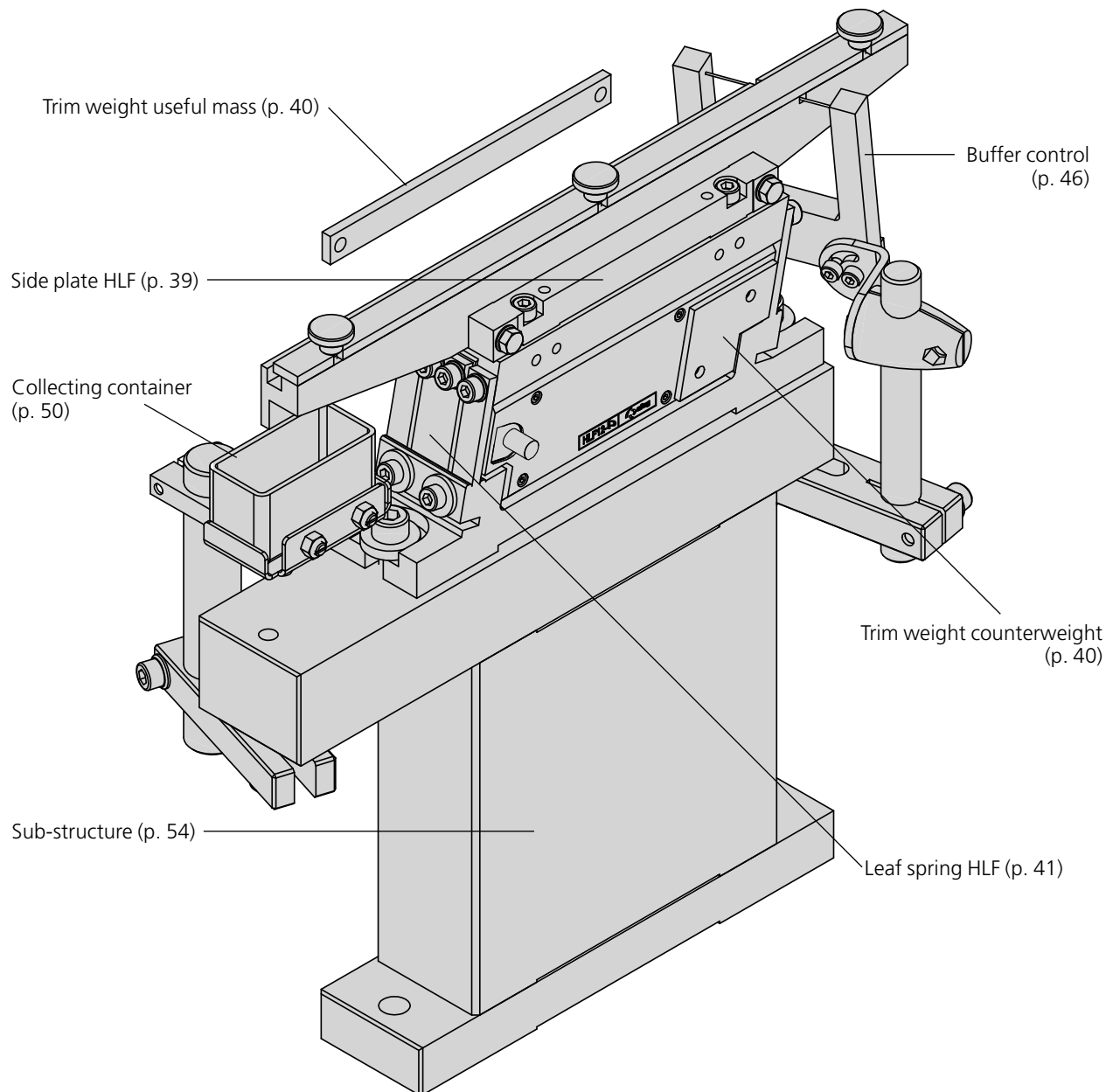

For fastening the rail to the HLF two variants are possible:

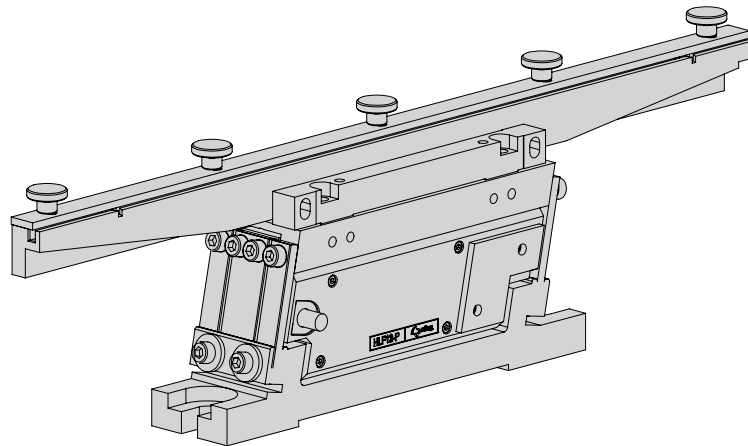

Variant 1 Construction with side plate O

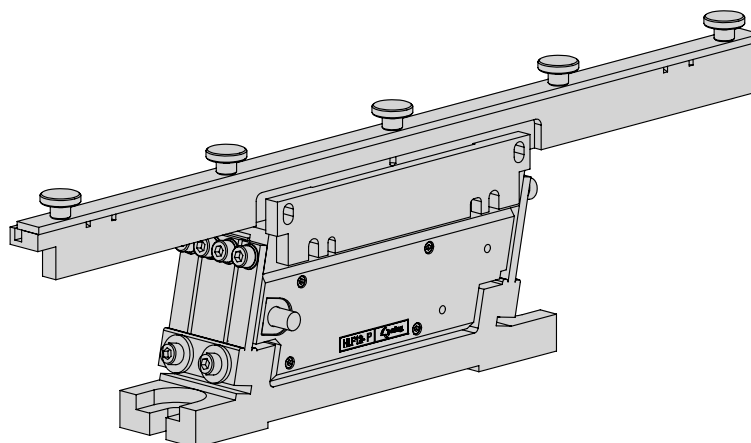

Variant 2 Construction with side plate S

Dimensions and dimension drawings

HLF-P

| Type | HLF07-P | HLF12-P |
|------|-------------|-------------|
| A | 300 mm | 400 mm |
| B | 25 mm | 30 mm |
| C | 10 mm | 10 mm |
| D1 | 7 mm | 9 mm |
| D2 | 4 x M5 | 4 x M5 |
| D3 | 2 x 4 H7 | 2 x 4 H7 |
| E | 36 mm | 42 mm |
| F | 73 mm | 80 mm |
| G | 80 mm | 100 mm |
| H | 60 mm | 69 mm |
| K | 60 mm | 80 mm |
| M | 170 mm | 200 mm |
| N | 4 mm | 4 mm |
| P | 150 mm | 180 mm |
| X | 85 ± 10 mm | 105 ± 10 mm |
| Y | 0 ± 9 mm | 0 ± 10 mm |
| Z | 77 ± 8,5 mm | 84 ± 11 mm |

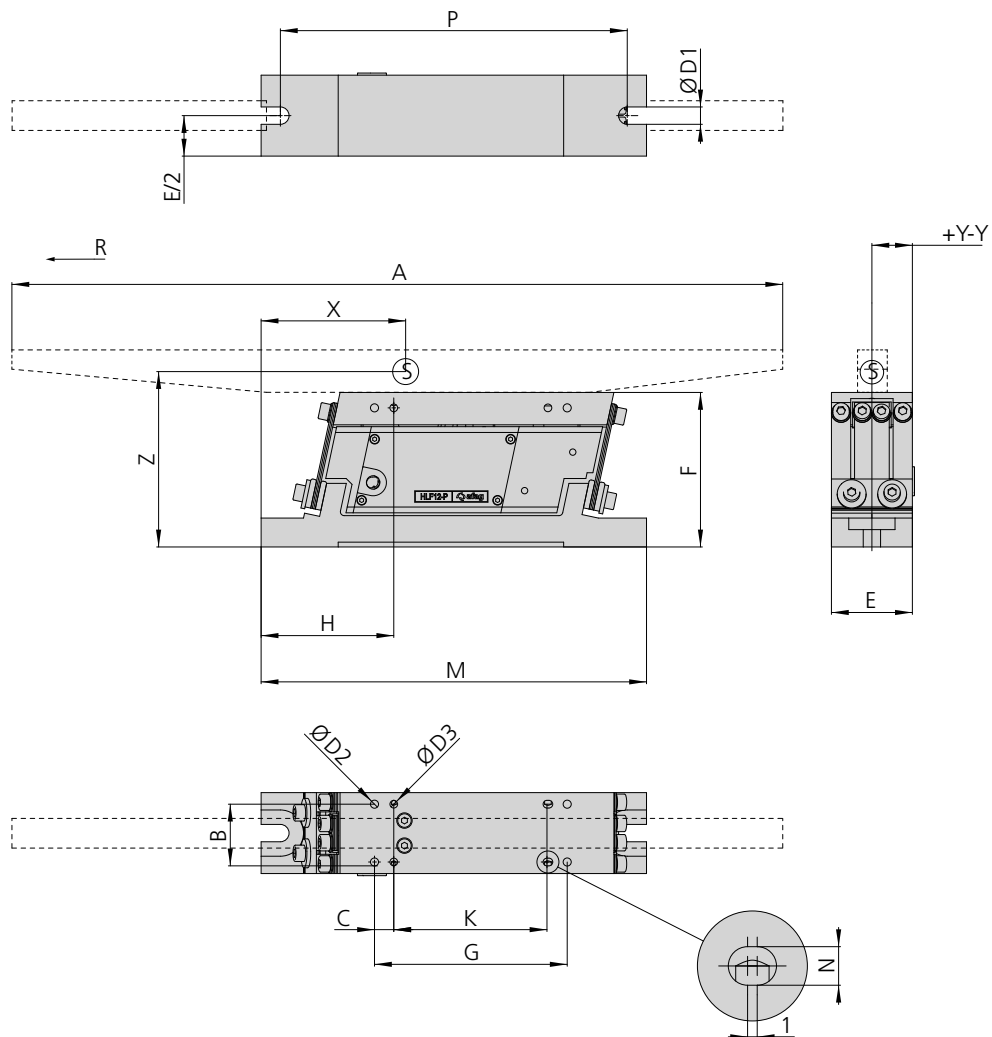

R = Feeding direction
S = Track center of gravity

Feeding technology components

| HLF-P | | |
|--|-----------------|-----------------|
| Operating temperature | 10 - 45 °C | |
| Type | HLF07-P | HLF12-P |
| Order number | 50260509 | 50259973 |
| Mechanical vibration frequency | 220 - 240 Hz | 190 - 210 Hz |
| Mains connection (mains voltage/mains frequency) | 230 V/50 Hz | 230 V/50 Hz |
| Max. power consumption | 23 VA | 23 VA |
| Net weight | 1.8 kg | 2.7 kg |
| Feed rail weight (ideal) | 0.7 ± 0.1 kg | 1.2 ± 0.1 kg |
| Max. feeder speed | 7 m/min | 7 m/min |
| Reactive force compensation | • | • |
| Protection type | IP 51 | IP 51 |

Note: • = existent

Track not included in scope of supply.